

GEO-STOR®

Geothermal Water Storage

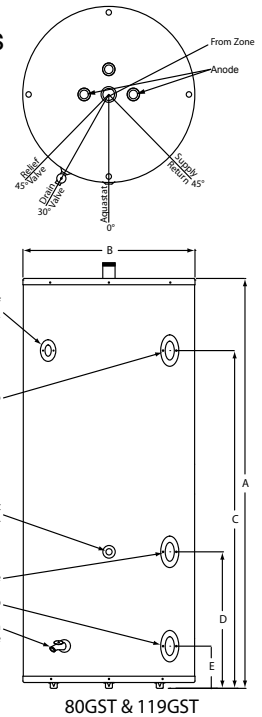

- ◆ *Cglass*®-porcelain fused-to-steel is impervious to chlorine and caustics - **the ideal water vessel**
- ◆ 30 to 119 gallon capacities (standard construction)
- ◆ ASME construction sized From 119 to 1000 gallons
- ◆ Magnesium anodes
- ◆ Steel exterior with powder coat finish
- ◆ 2" top and side NPT connections
- ◆ Factory installed brass drain valve
- ◆ 5-Year tank warranty - residential applications
- ◆ 3-Year tank warranty - non-residential applications

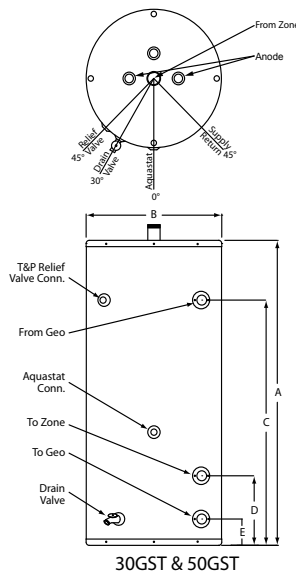

Model	Storage (gal)	T&P Relief Valve Conn.	Supply/Return Conn.	Outlet Conn.	Aquastat Conn.	Dimensions					Shipping Weight (lbs)
						A	B	C	D	E	
30GST	30	3/4"	2"	2"	3/4"	39 1/2"	20"	30"	11 1/16"	4 3/16"	150
50GST	50	3/4"	2"	2"	3/4"	48 1/2"	22"	39"	11 1/16"	4 3/16"	190
80GST	80	1"	2"	2"	3/4"	60 1/2"	24"	50"	21"	6"	250
119GST-2"	119	1"	2"	2"	3/4"	65 1/2"	28"	54"	22"	7"	385

*Additional sizes to 1,000 gallon capacities available in ASME and Standard Construction.

Warning: Installation should be in accordance with all national and/or local codes. In the absence of local codes, refer to NFPA 54 or ANSI Z21.10.1.

Caution: The recommended maximum hot water temperature setting for normal residential use is 120° F. Manufacturer recommends a tempering valve or anti-scald valve be installed and used according to the manufacturer's directions to prevent scalding.

Pressures (all): Working Pressure, 150 psi; Testing Pressure, 300 psi

Universal Technologies of Wisconsin, Inc.
110 South Dickinson Street, Madison, Wisconsin 53703
Toll Free 866-759-0067 • Fax 608-257-5304
WWW.GEOSTOR.NET